

repair parts

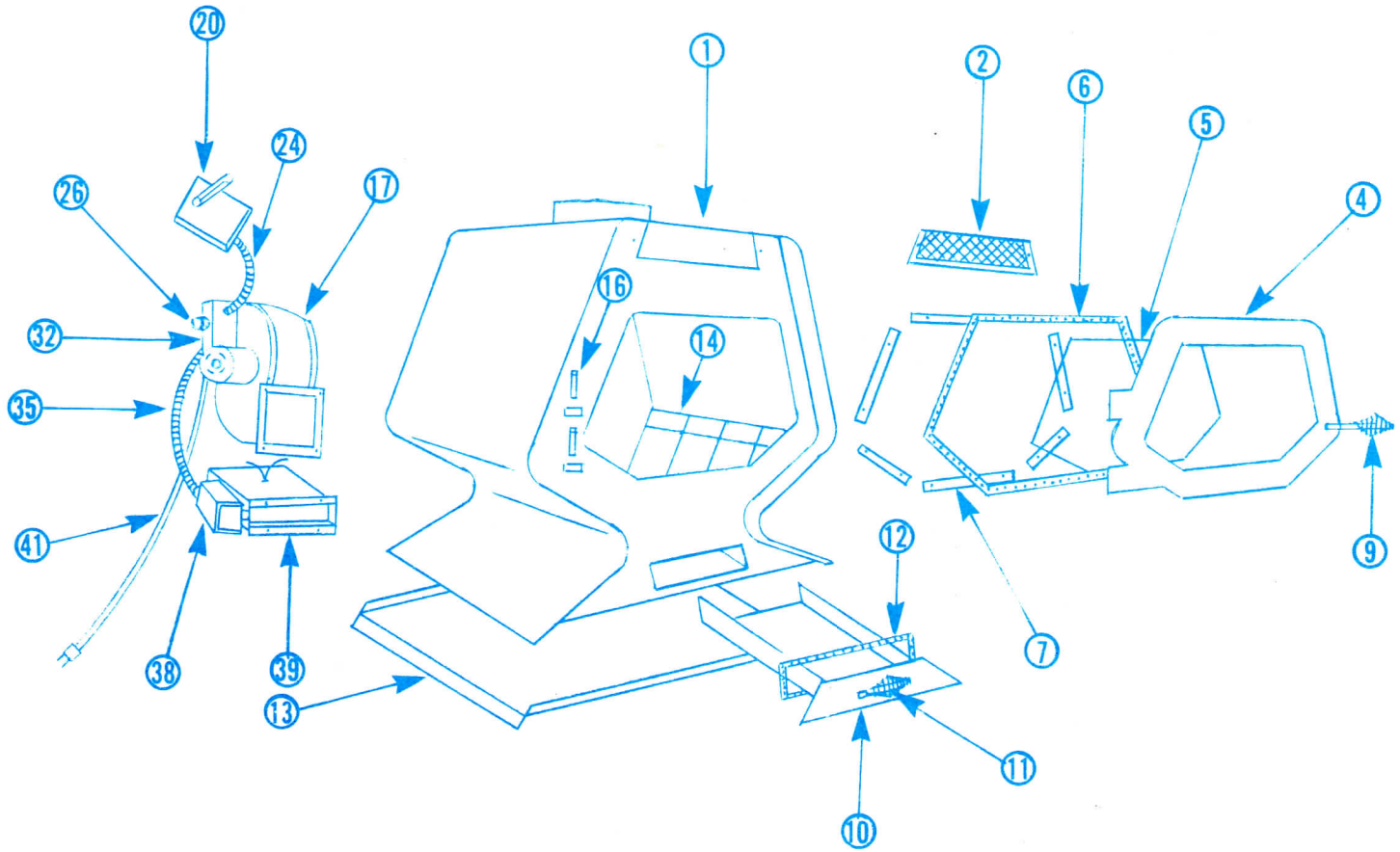

Key No.	Part No.	Part Description
1	4001	Chamber Weldment
2	4002	Outlet Grill, specify nickel or brass
3	1001	#10 x 1/2 Screws for outlet grill, (2 req.)*
4	2001	Cast Iron Doors, specify nickel or brass
5	1002	Door Glass 1400°
6	1003	Glass Seal
7	4003	Glass Mounting Brackets
8	1004	Door Seal 5/8 rd.*
9	1005	Spring Handle, Door
10	4004	Ash Pan
11	1005	Spring Handle, Ash Pan, specify nickel or brass
12	1006	Ash Pan Seal, 3/8 rd.
13	3001	Floor Heat Shield
14	2002	Firebrick, (16 pcs. req.)
15	1007	Cast Iron Grate*
16	1008	Hinge Pins, (2 req.)
17	2003	Blower
18	1009	Blower Mounting Bolts, 1/4-20 x 1, (4 req.)*
19	1010	Tinnerman Clips for Mounting Blower, (4 req.)
20	2004	Thermostat and Fan Limit Control
21	1011	Fan Limit Mounting Bracket

Key No.	Part No.	Part Description
22	1012	Fan Limit Mounting Screws, #10 x 1/2, (2 req.)
23	1013	3/8" Straight Cable Connectors, (2 req.)
24	1014	3/8" Aluminum Cable, 8"
25	1015	18 gauge 105° AWG wire, 16", (3 pcs. req.)*
26	1016	Junction Box
27	3002	Junction Box Cover*
28	1017	Cover Screws 6-32 x 1/2", (2 req.)*
29	1018	Ground Screw 10-32 x 3/8"
30	1019	Wire Nuts, (5 req.)*
31	1020	1/2" Box Connector*
32	2005	Variable Speed Control
33	1021	Speed Control Knob*
34	1022	3/8" 90° Cable Connector*
35	1023	3/8" Aluminum Cable, 14"
36	1013	3/8" Straight Cable Connector*
37	1024	18 gauge 105° AWG Wire, 22", (2 req.)
38	2006	Draft Control Motor
39	4005	Air Intake Enclosure
40	1012	Air Intake Enclosure Mounting Screws #10 x 1/2, (4 req.)
41	1025	Power Supply Cord SJT, 6 ft.
42	1026	Cord Connector*

*Not Illustrated

WHEN ORDERING REPAIR PARTS ALWAYS GIVE THE FOLLOWING INFORMATION:

1. Part Number and A for Aurora, O for Orion
2. Part Description
3. Model Name or Number
4. Name of Item