

Auger Motor Bracket Kit

Part #MF3636

new upgrade bracket for Models 3500P, 3500L, 3502, 7500 that are using older systems of auger brackets
(must have a 1 1/2" dia. auger weldment)

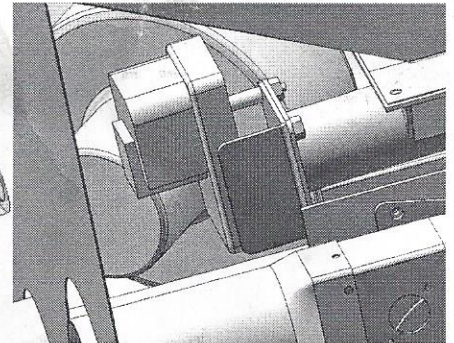
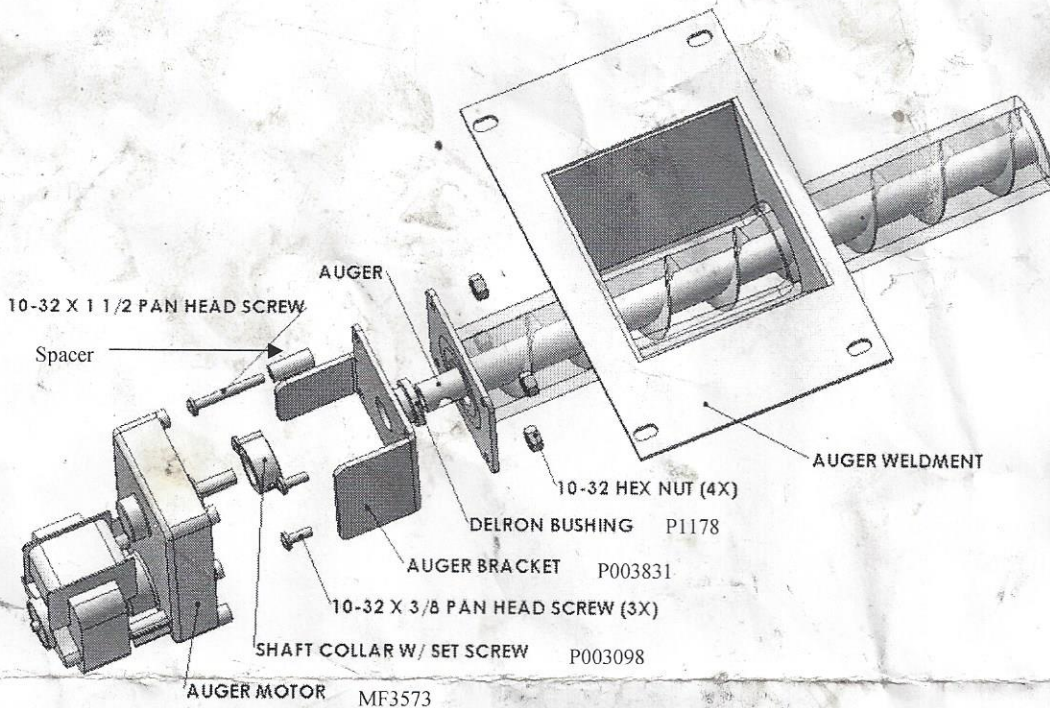

Looking in from LH side

Looking in from RH side

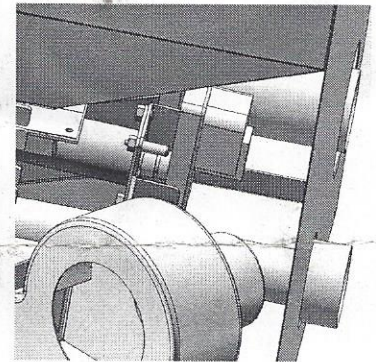

- Turn off power on control panel and unplug cord from the power supply.
- Open right side panel of furnace being careful not to pull on wire harness as you open the cabinet. Might want to open left cabinet door for extra light and accessibility to auger system.
- Loosen bolts or collars and slide auger motor off of old system. Disassemble old auger bracket system, clean area around plate welded onto auger housing, discard all old parts.
- Note: If you have the auger bracket system where the 4 long bolts are welded to the auger plate, you will have to grind off the welds to get the bolts off. If you have the CF35 bracket system you will need to unbolt and discard the bracket that is bolted to the plate that is welded onto the auger housing and remove the Black 1' long Delron bushing out of the inside of the auger tube. Remove the auger at this time, you will not be using it with the new bracket system.
- Slide new auger MF3553 (ordered separately) into the auger tube with the shaft end coming out the back of the auger housing and make sure that the Delron Bushing (P1178) is installed as shown.
- Put on new bracket using the (3) 10-32 x 3/8" pan head screws, (1) 10-32 x 1 1/4" pan head screw, 3/4" spacer and the (4) 10-32 hex nuts putting the (1) 10-32 x 1 1/4" with spacer in corner as shown.
- Slide the shaft collar on auger shaft, aligning the set screw to the hole on the auger shaft.
- Slide on the auger motor by aligning the flat shaft on the auger to the Allen screw on shaft collar and then tighten the set screw on the collar. Auger motor should be up against the spacer in the upper corner of the bracket.
- Reconnect auger motor electrical leads and make sure wires are secured properly in the right panel.
- Close side panel, plug unit in, test run auger system to be sure that it works. Restart and use unit.