

GARAGE WALL DETAIL AS INSTALLED 2009

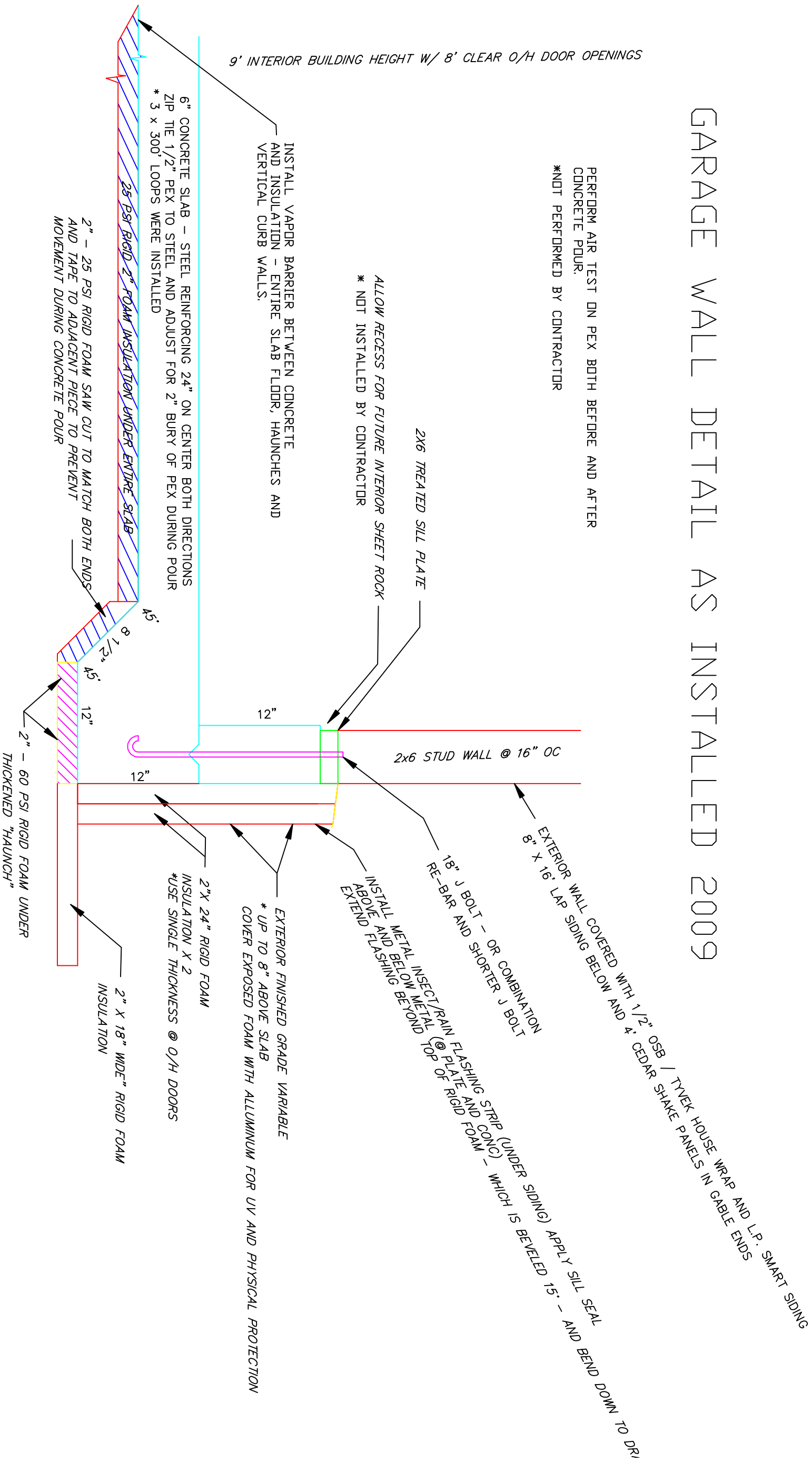

AS REV'D 02/05/11

INCLUDE RE-BAR X 2 IN THICKENED PERIMETER HAUNCH AND ALSO "CURB WALL" - EXCEPT AT OVERHEAD DOORS WHERE X4 RE-BAR IS TO BE USED IN THICKENED HAUNCH